

NICOLE JONES, MBA, MS
President, Nicole Jones Commercial Real Estate
Business: (256) 886-7700
*Specializing in Properties Located Within
Huntsville City Limits*

*Have Confidence in Nicole Jones, a Commercial Real Estate
Professional with a Background in Business and Development—*

Bachelor of Arts in History
- Research interests in Government and Public Policy
Master of Business Administration
Master of Science in Acquisition and Contract Management
Certified Alabama Planning and Zoning Official
Economic Development Leadership Certification

NICOLE JONES
COMMERCIAL REAL ESTATE

For Lease— Free-Standing Office or Multipurpose Building

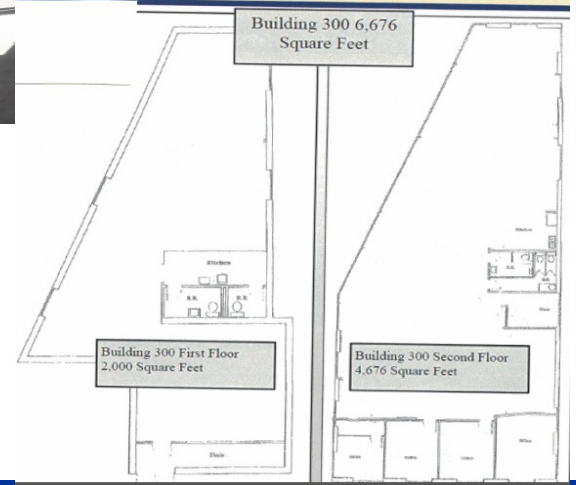

\$4,895
per month

3322 Memorial Parkway SW, Suite 300, Huntsville, AL 35801

FOR LEASE— Office or Multipurpose Building

- Free-standing building
- Approximately 6,676 square feet
- Centrally located
- Two Levels—Open areas and large offices / Owner will permit build-out of additional rooms and offices
- Ample parking, including covered parking
- Abundance of natural light and views
- **\$4,895 per month AS-IS**

Renovations are underway at The Century Office complex, which include new paving and striping of the parking lot and the demolition of an older structure to create additional parking for guests. The site is conveniently located on Memorial Parkway south of Drake Avenue, just a few moments from I-565, which offers business owners the ability to attract customers from Huntsville, Redstone Arsenal, and the surrounding area.

This information contained herein was obtained from sources deemed to be reliable; however, Nicole Jones Commercial Real Estate makes no guarantees, warranties or representations as to the completeness or accuracy thereof.